

# Roanoke County Schools

## Three Year AHERA Reinspection

Mount Pleasant Elementary School  
Facility 023

---

Reinspection Date:

June 10, 2008

***Baratta & Associates, Inc***

PO Box 293

Vinton, Virginia 24179

540-890-4875

Michael Baratta, PE

Virginia Asbestos Inspector License: 3303-000065

Virginia Asbestos Management Planner License: 3304-000208

**Baratta & Associates, Inc.**

Virginia Department of Education  
Energy and Facilities Service

LEA Roanoke County Schools  
School 023 Mount Pleasant Elementary School  
Building Main

**SCHOOL BUILDINGS**

Building Name	Location	Check here for the presence of:				No ACBM
		ACBM		Suspect ACBM		
		Friable	Non- friable	Friable	Non- friable	
Mount Pleasant Elementary School (023)	3216 Mt Pleasant Boulevard	X	X			

Inspector:

Name: Michael BarattaSignature Date 7/23/09Accreditation Number: 3303 000065 Agency: Virginia DPOR

Virginia Department of Education  
Energy and Facilities Services

LEA Roanoke County Schools  
School: 023 Mount Pleasant E/S  
Building: Main

### DETERMINATION OF EACH SAMPLE AREA

H-K had only evaluated floor tiles HA-12 and HA-14. We divided these materials into their tile (A) and mastic (B) fractions and obtained two (2) samples each.

We did not use a random number sample scheme to determine the sample locations of Plaster 23. We obtained the nine (9) recommended samples from reprehensive areas within the school.

Numerous additional floor tiles and underlayments were encountered. We took two (2) samples of the tiles and associated mastics.

Two samples of acoustical ceiling tile (HA-45) were also obtained.

Homogeneous Area	Material	Sample Number	Location
12B	Black mastic for brown 9"x9", HA-12A	12B-1	205, center of S wall at closet
		12B-2	205, center of S wall at closet
14B	Black mastic for tan 9"x9" floor tile HA-14A	14B-1	203, center of E wall at closet
		14B-2	203, center of E wall at closet
23	Plaster	23-1	Media Center, center of N wall
		23-2	Special Education E, SW corner
		23-3	208, NW corner
		23-4	203, SE corner
		23-5	207, SE corner
		23-6	103, NW corner
		23-7	104, NW corner
		23-8	106, SW corner
		23-9	Davidson, NW corner
24	Tan mastic for blue carpet	24-1	Public Library, NW corner
		24-2	Public Library, NW corner
25	Floor tile 12" x12", white under HA-24	25-1	Public Library, NW corner
		25-2	Public Library, NW corner
26	Black mastic for HA-25	26-1	Public Library, NW corner
		26-2	Public Library, NW corner
27	Floor tile 12" x12", tan with brown & white	27-1	First floor, E hall center of W wall
		27-2	Second floor, E hall center of W wall
28	Black mastic for HA-27	28-1	First floor, E hall center of W wall
		28-2	Second floor, E hall center of W wall
29	Floor tile 12" x12", cream with almond	29-1	Hall at 208
		29-2	Hall at 215

30	Black mastic for HA-29	30-1	Hall at 208
		30-2	Hall at 215
31	Floor tile 12" x12", white with grey streaks	31-1	First floor at entrance
		31-2	Hall at 103
32	Black mastic for HA-31	32-1	First floor at entrance
		32-2	Hall at 103
33	Brown floor tile under HA-31	33-1	First floor at entrance
		33-2	Hall at 103
34	Black mastic for HA-33	34-1	First floor at entrance
		34-2	Hall at 103
35	Floor tile 12" x12" grey with white & blue	35-1	Special Education W, NW corner
		35-2	201, SW corner
36	Tan mastic for HA-35	36-1	Special Education W, NW corner
		36-2	201, SW corner
37	Black floor tile under HA-35 in Special Education	37-1	Special Education W, NW corner
		37-2	Special Education W, NW corner
38	Black mastic for HA-37	38-1	Special Education W, NW corner
		38-2	Special Education W, NW corner
39	Floor tile 12" x12" white with cream	39-1	Workroom center of N wall
		39-2	Workroom center of N wall
40	Black mastic for HA-39	40-1	Workroom center of N wall
		40-2	Workroom center of N wall
41	Floor tile 12" x12", white with taupe	41-1	File Room, SE corner
		41-2	File Room, SE corner
42	Brown mastic for HA-41	42-1	File Room, SE corner
		42-2	File Room, SE corner
43	White floor tile under HA-41	43-1	File Room, SE corner
		43-2	File Room, SE corner
44	Black mastic for HA-43	44-1	File Room, SE corner
		44-2	File Room, SE corner
45	ACT 12"x12"	45-1	Media Center, NW corner
		45-2	Media Center, SE corner

Name: Michael Baratta

Signature



Date 7/23/04

Accreditation Number: 3303 000065 Agency: Virginia DPOR

AHERA Three Year Inspection  
 Mount Pleasant Elementary School  
 Roanoke County Schools  
 Sample dates:  
 Building 023  
 Sample Locations  
 L002  
 June 10, 2008

HA-23 Plaster  
 Samples ; 23-6; 23-7; 23-8; 23-9  
 HA-24 Tan mastic for blue carpet  
 Samples 24-1; 24-2

HA-25 Floor tile 12"x12" white under HA-24  
 Samples 25-1; 25-2

HA-26 Black mastic for HA-23  
 Samples 26-1; 26-2

HA-27 Floor tile 12"x12" tan w/ brown & white  
 Samples 27-1

HA-28 Black mastic for HA-27  
 Samples 28-1

HA-31 Floor tile 12"x12" white 2/ grey streaks  
 Samples 31-1; 31-2

HA-32 Black mastic for HA-31  
 Samples 32-1; 32-2

HA-33 Brown floor tile under HA-31  
 Samples 33-1; 33-2

HA-34 Black mastic for HA-33  
 Samples 34-1; 34-2

HA-39 Floor tile 12"x12" white w/ cream  
 Samples 39-1; 39-2

HA-40 Black mastic for HA-39  
 Samples 40-1; 40-2

HA-41 Floor tile 12"x12", white w/ taupe  
 Samples 41-1; 41-2

HA-42 Brown mastic for HA-41  
 Samples 42-1; 42-2

HA-43 White floor tile under HA-41  
 Samples 43-1; 43-2

HA-44 Black mastic for HA-43  
 Samples 44-1; 44-2

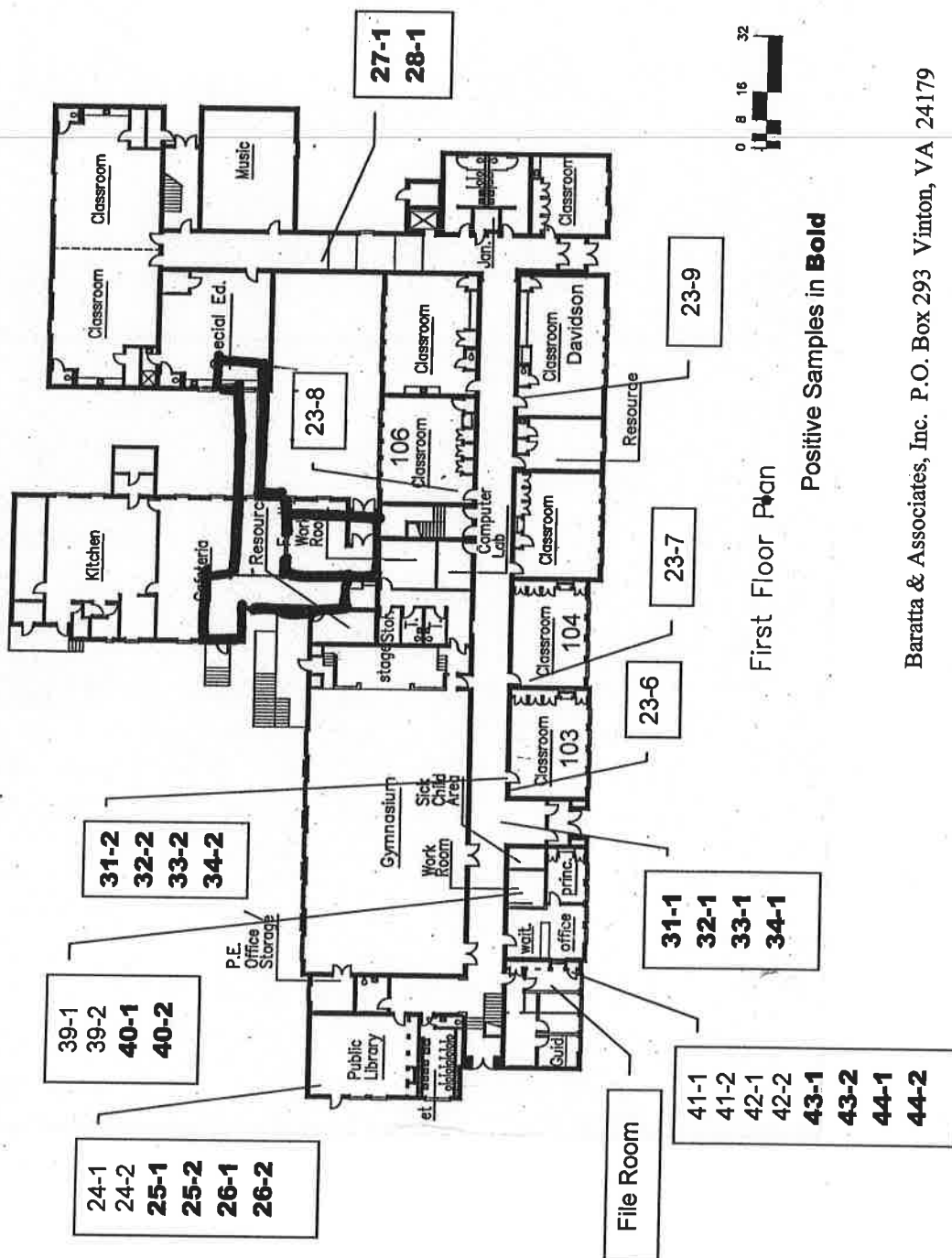

BN

AHERA Three Year Inspection  
 Mount Pleasant Elementary School  
 Roanoke County Schools  
 Sample date:

Building 023  
 Sample Locations  
 L001  
 June 10, 2008

- HA-12B Black mastic for brown 9"x9" HA-12A  
 Samples 12B-1; 12B-2  
 HA-14B Black mastic for tan 9"x9" floor tile  
 HA-14A  
 Samples 14B-1; 14B-2  
 HA-23 Plaster  
 Samples 23-1; 23-2; 23-3; 23-4; 23-5  
 HA-27 Floor tile 12"x12", tan w/ brown & white  
 Samples 27-2  
 HA-28 Black mastic for HA-27  
 Samples 28-2  
 HA-29 Floor tile 12"x12", cream w/ almond  
 Sample 29-1; 29-2  
 HA-30 Black mastic for HA-29  
 Sample 30-1; 30-2  
 HA-35 Floor tile 12"x12" grey w/ white & blue  
 Samples 35-1; 35-2  
 HA-36 Tan mastic for HA-35  
 Samples 36-1; 36-2  
 HA-37 Black floor tile under HA-35 in Spec. Ed.  
 Samples 37-1; 37-2  
 HA-38 Black mastic for HA-37  
 Samples 38-1; 38-2  
 HA-45 ACT 12"x12"  
 Samples 45-1; 45-2

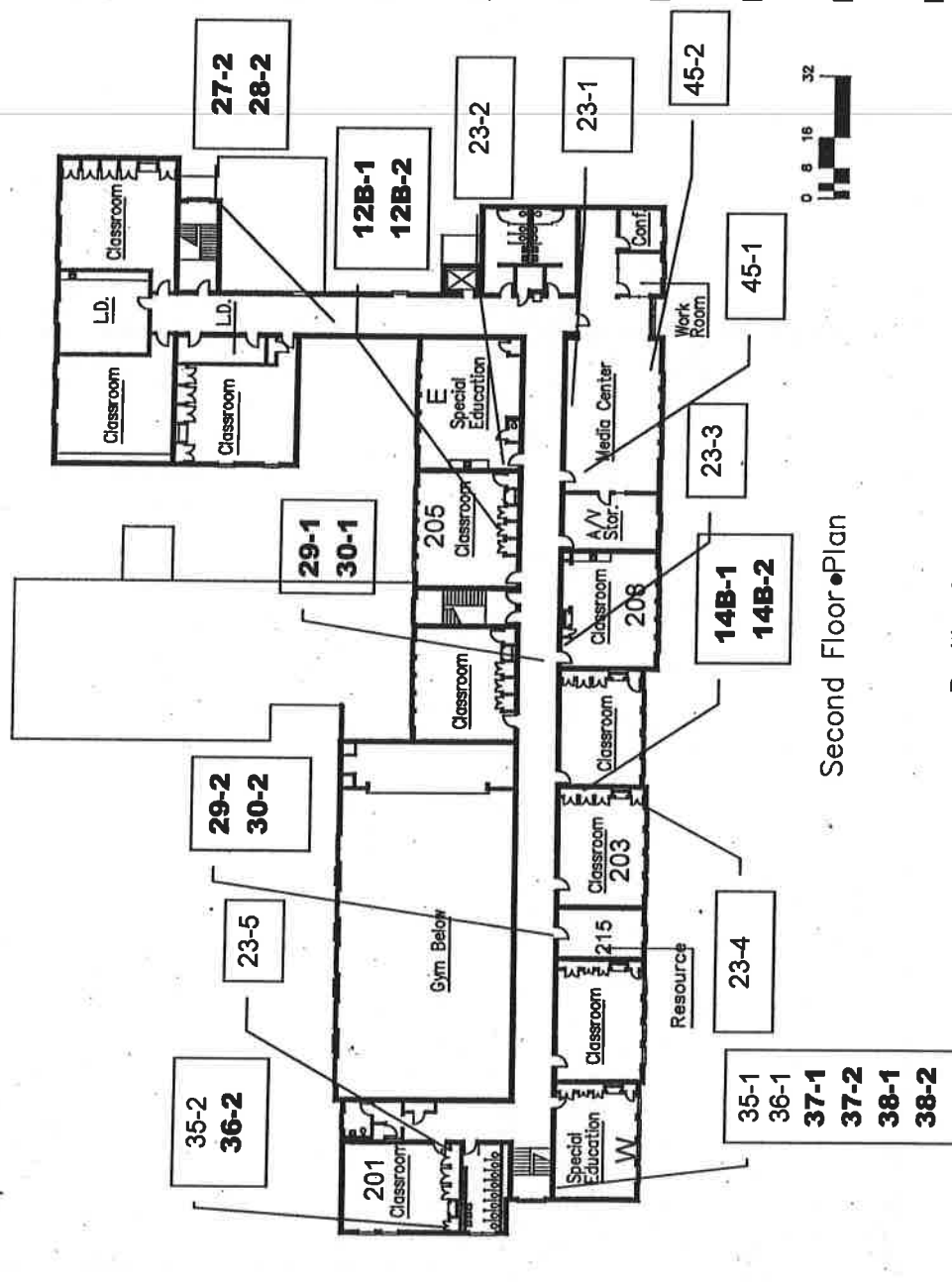

Virginia Department of Education  
Energy and Facilities Services

Document E.1

LEA Roanoke County Schools  
School: 023 Mount Pleasant Elementary School  
Building: Main  
Sample Date: June 10, 2008  
Analysis Date: \_\_\_\_\_  
Analysis Method: PLM EPA 6000/M4-82-020

**BULK SAMPLE ANALYSIS**

Homogeneous Area	Sample Number	Material	Asbestos Content
12B	12B-1	Black mastic for brown 9"x9", HA-12A	6 % chrysotile
	12B-1		6 % chrysotile
14B	14B-1	Black mastic for tan 9"x9" floor tile HA-14A	8 % chrysotile
	14B-2		6 % chrysotile
23	23-1	Plaster	NAD
	23-2		NAD
	23-3		NAD
	23-4		NAD
	23-5		NAD
	23-6		NAD
	23-7		NAD
	23-8		NAD
	23-9		NAD
24	24-1	Tan mastic for blue carpet	NAD
	24-2		NAD
25	25-1	Floor tile 12" x12", white under HA-24	2 % chrysotile
	25-2		2 % chrysotile
26	26-1	Black mastic for HA-25	3 % chrysotile
	26-2		2 % chrysotile
27	27-1	Floor tile 12" x12", tan with brown & white	2 % chrysotile
	27-2		2 % chrysotile
28	28-1	Black mastic for HA-27	3 % chrysotile
	28-2		3 % chrysotile
29	29-1	Floor tile 12" x12", cream with almond	2 % chrysotile
	29-2		2 % chrysotile
30	30-1	Black mastic for HA-29	4 % chrysotile
	30-2		4 % chrysotile
31	31-1	Floor tile 12" x12", white with grey streaks	2 % chrysotile
	31-2		2 % chrysotile
32	32-1	Black mastic for HA-31	3 % chrysotile
	32-2		3 % chrysotile
33	33-1	Brown floor tile under HA-31	10 % chrysotile
	33-2		10 % chrysotile

34	34-1	Black mastic for HA-33	8 % chrysotile
	34-2		8 % chrysotile
35	35-1	Floor tile 12" x12" grey with white & blue	NAD
	35-2		NAD
36	36-1	Tan mastic for HA-35	NAD
	36-2		3 % chrysotile
37	37-1	Black floor tile under HA-35 in Special Education	7 % chrysotile
	37-2		7 % chrysotile
38	38-1	Black mastic for HA-37	8 % chrysotile
	38-2		8 % chrysotile
39	39-1	Floor tile 12" x12" white with cream	NAD
	39-2		NAD
40	40-1	Black mastic for HA-39	5 % chrysotile
	40-2		5 % chrysotile
41	41-1	Floor tile 12" x12", white with taupe	NAD
	41-2		NAD
42	42-1	Brown mastic for HA-41	NAD
	42-2		NAD
43	43-1	White floor tile under HA-41	3 % chrysotile
	43-2		3 % chrysotile
44	44-1	Black mastic for HA-43	5 % chrysotile
	44-2		5 % chrysotile
45	45-1	ACT 12"x12"	NAD
	45-2		NAD

NAD – no asbestos detected

See attached AmeriSci PLM Bulk Asbestos Report Number 108061421

Name: Michael Baratta

Signature



Date 7/23/06

Accreditation Number: 3303 000065 Agency: Virginia DPOR



June 16, 2008

Baratta & Associates, Inc.  
Attn: Michael Baratta  
1150 Shady Run Road  
Vinton, VA 24179

RE: Baratta & Associates, Inc.  
Job Number 108061421  
P.O. #L001  
L001; AHERA; Mount Pleasant Els

Dear Michael Baratta:

Enclosed are the results for PLM asbestos analysis of the following Baratta & Associates, Inc. samples received at AmeriSci on Friday, June 13, 2008, for a 3 day turnaround:

12B-1, 12B-2, 14B-1, 14B-2, 23-1, 23-2, 23-3, 23-4, 23-5, 23-6, 23-7, 23-8, 23-9, 24-1, 24-2, 25-1, 25-2, 26-1, 26-2, 27-1, 27-2, 28-1, 28-2, 29-1, 29-2, 30-1, 30-2, 31-1, 31-2, 32-1, 32-2, 33-1, 33-2, 34-1, 34-2, 35-1, 35-2, 36-1, 36-2, 37-1, 37-2, 38-1, 38-2, 39-1, 39-2, 40-1, 40-2, 41-1, 41-2, 42-1, 42-2, 43-1, 43-2, 44-1, 44-2, 45-1, 45-2

The 57 samples contained in zip lock bag were shipped to AmeriSci via Fed Ex 8621 8375 0492 B. These samples were prepared and analyzed according to the EPA Interim Method (EPA 600/M4-82-020 per 40 CFR 763, subpt F, App. A). The required analytical information, analysis results, analyst signature and laboratory identification is contained in the Analyst's Report.

This report relates ONLY to the sample analysis expressed as percent asbestos. AmeriSci assumes no responsibility for customer supplied data such as "sample type", "location", or "area sampled". This report must not be used to claim product endorsement by AmeriSci, NVLAP or any agency of the U. S. Government. The National Institute of Standards and Technology Accreditation requirements, mandates that this report must not be reproduced, except in full without the written approval of the laboratory. This report may contain specific data not covered by NVLAP or ELAP accreditations respectively, if so identified in relevant footnotes.

AmeriSci appreciates this opportunity to serve your organization. Please contact us for any further assistance or with any questions.

Sincerely,

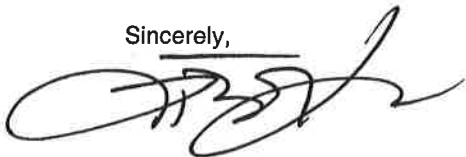

T. Brian Keith  
Asbestos Laboratory Director



**AmeriSci Richmond**  
13635 GENITO ROAD  
MIDLOTHIAN, VIRGINIA 23112  
TEL: (804) 763-1200 • FAX: (804) 763-1800

## PLM Bulk Asbestos Report

Baratta & Associates, Inc.  
Attn: Michael Baratta  
1150 Shady Run Road  
  
Vinton, VA 24179

**Date Received** 06/13/08    **AmeriSci Job #** 108061421  
**Date Examined** 06/16/08    **P.O. #**  
**Page** 1 **of** 10  
**RE:** L001; AHERA; Mount Pleasant Els

Client No. / HGA	Lab No.	Asbestos Present	Total % Asbestos
12B-1 Location: Floor Tile Mastic	108061421-01	Yes	6 % (by CVES) by Donna M. Blackwell on 06/16/08
<b>Analyst Description:</b> Black, Homogeneous, Non-Fibrous, Bulk Material <b>Asbestos Types:</b> Chrysotile 6.0 % <b>Other Material:</b> Cellulose 3 %, Non-fibrous 91 %			
12B-2 Location: Floor Tile Mastic	108061421-02	Yes	6 % (by CVES) by Donna M. Blackwell on 06/16/08
<b>Analyst Description:</b> Black, Homogeneous, Non-Fibrous, Bulk Material <b>Asbestos Types:</b> Chrysotile 6.0 % <b>Other Material:</b> Cellulose 3 %, Non-fibrous 91 %			
14B-1 Location: Floor Tile Mastic	108061421-03	Yes	8 % (by CVES) by Donna M. Blackwell on 06/16/08
<b>Analyst Description:</b> Black, Homogeneous, Non-Fibrous, Bulk Material <b>Asbestos Types:</b> Chrysotile 8.0 % <b>Other Material:</b> Cellulose 2 %, Non-fibrous 90 %			
14B-2 Location: Floor Tile Mastic	108061421-04	Yes	6 % (by CVES) by Donna M. Blackwell on 06/16/08
<b>Analyst Description:</b> Black, Homogeneous, Non-Fibrous, Bulk Material <b>Asbestos Types:</b> Chrysotile 6.0 % <b>Other Material:</b> Non-fibrous 94 %			
23-1 Location: Plaster	108061421-05	No	NAD (by CVES) by Donna M. Blackwell on 06/16/08
<b>Analyst Description:</b> White/Beige, Homogeneous, Non-Fibrous, Cementitious, Bulk Material <b>Asbestos Types:</b> <b>Other Material:</b> Non-fibrous 100 %			

# PLM Bulk Asbestos Report

L001; AHERA; Mount Pleasant Els

Client No. / HGA	Lab No.	Asbestos Present	Total % Asbestos
23-2  Location: Plaster	108061421-06	No	NAD (by CVES) by Donna M. Blackwell on 06/16/08
Analyst Description: White/Beige, Homogeneous, Non-Fibrous, Cementitious, Bulk Material Asbestos Types: Other Material: Non-fibrous 100 %			
23-3  Location: Plaster	108061421-07	No	NAD (by CVES) by Donna M. Blackwell on 06/16/08
Analyst Description: White/Gray, Homogeneous, Non-Fibrous, Cementitious, Bulk Material Asbestos Types: Other Material: Non-fibrous 100 %			
23-4  Location: Plaster	108061421-08	No	NAD (by CVES) by Donna M. Blackwell on 06/16/08
Analyst Description: White/Gray, Homogeneous, Non-Fibrous, Cementitious, Bulk Material Asbestos Types: Other Material: Non-fibrous 100 %			
23-5  Location: Plaster	108061421-09	No	NAD (by CVES) by Donna M. Blackwell on 06/16/08
Analyst Description: White/Gray, Homogeneous, Non-Fibrous, Cementitious, Bulk Material Asbestos Types: Other Material: Non-fibrous 100 %			
23-6  Location: Plaster	108061421-10	No	NAD (by CVES) by Donna M. Blackwell on 06/16/08
Analyst Description: White/Beige, Homogeneous, Non-Fibrous, Cementitious, Bulk Material Asbestos Types: Other Material: Non-fibrous 100 %			
23-7  Location: Plaster	108061421-11	No	NAD (by CVES) by Donna M. Blackwell on 06/16/08
Analyst Description: White/Beige, Homogeneous, Non-Fibrous, Cementitious, Bulk Material Asbestos Types: Other Material: Non-fibrous 100 %			

Client Name: Baratta &amp; Associates, Inc.

**PLM Bulk Asbestos Report**

L001; AHERA; Mount Pleasant Els

Client No. / HGA	Lab No.	Asbestos Present	Total % Asbestos
23-8 Location: Plaster	108061421-12	No	NAD (by CVES) by Donna M. Blackwell on 06/16/08
<b>Analyst Description:</b> White, Homogeneous, Non-Fibrous, Cementitious, Bulk Material <b>Asbestos Types:</b> <b>Other Material:</b> Non-fibrous 100 %			
23-9 Location: Plaster	108061421-13	No	NAD (by CVES) by Donna M. Blackwell on 06/16/08
<b>Analyst Description:</b> White/Beige, Homogeneous, Non-Fibrous, Bulk Material <b>Asbestos Types:</b> <b>Other Material:</b> Non-fibrous 100 %			
24-1 Location: Carpet Mastic	108061421-14	No	NAD (by CVES) by C. David Mintz on 06/16/08
<b>Analyst Description:</b> Yellow-Tan, Homogeneous, Non-Fibrous, Mastic <b>Asbestos Types:</b> <b>Other Material:</b> Cellulose Trace, Synthetic fibers 1 %, Non-fibrous 99 %			
24-2 Location: Carpet Mastic	108061421-15	No	NAD (by CVES) by C. David Mintz on 06/16/08
<b>Analyst Description:</b> Yellow-Tan, Heterogeneous, Non-Fibrous, Mastic <b>Asbestos Types:</b> <b>Other Material:</b> Cellulose Trace, Synthetic fibers Trace, Non-fibrous 100 %			
25-1 Location: Floor Tile	108061421-16	Yes	2 % (by CVES) by C. David Mintz on 06/16/08
<b>Analyst Description:</b> Off White, Homogeneous, Non-Fibrous, Floor Tile <b>Asbestos Types:</b> Chrysotile 2.0 % <b>Other Material:</b> Non-fibrous 98 %			
25-2 Location: Floor Tile	108061421-17	Yes	2 % (by CVES) by C. David Mintz on 06/16/08
<b>Analyst Description:</b> Off White, Homogeneous, Non-Fibrous, Floor Tile <b>Asbestos Types:</b> Chrysotile 2.0 % <b>Other Material:</b> Non-fibrous 98 %			

Client Name: Baratta &amp; Associates, Inc.

**PLM Bulk Asbestos Report**

L001; AHERA; Mount Pleasant Els

Client No. / HGA	Lab No.	Asbestos Present	Total % Asbestos
26-1	108061421-18	Yes	3 %
Location: Floor Tile Mastic			(by CVES) by C. David Mintz on 06/16/08
Analyst Description: Black, Heterogeneous, Non-Fibrous, Mastic			
Asbestos Types: Chrysotile 3.0 %			
Other Material: Cellulose 2 %, Non-fibrous 95 %			
26-2	108061421-19	Yes	2 %
Location: Floor Tile Mastic			(by CVES) by C. David Mintz on 06/16/08
Analyst Description: Black, Heterogeneous, Non-Fibrous, Mastic			
Asbestos Types: Chrysotile 2.0 %			
Other Material: Cellulose 3 %, Non-fibrous 95 %			
27-1	108061421-20	Yes	2 %
Location: Floor Tile			(by CVES) by C. David Mintz on 06/16/08
Analyst Description: Off White, Homogeneous, Non-Fibrous, Floor Tile			
Asbestos Types: Chrysotile 2.0 %			
Other Material: Non-fibrous 98 %			
27-2	108061421-21	Yes	2 %
Location: Floor Tile			(by CVES) by C. David Mintz on 06/16/08
Analyst Description: Off White, Homogeneous, Non-Fibrous, Floor Tile			
Asbestos Types: Chrysotile 2.0 %			
Other Material: Non-fibrous 98 %			
28-1	108061421-22	Yes	3 %
Location: Floor Tile Mastic			(by CVES) by C. David Mintz on 06/16/08
Analyst Description: Black, Heterogeneous, Non-Fibrous, Mastic			
Asbestos Types: Chrysotile 3.0 %			
Other Material: Cellulose 3 %, Non-fibrous 94 %			
28-2	108061421-23	Yes	3 %
Location: Floor Tile Mastic			(by CVES) by C. David Mintz on 06/16/08
Analyst Description: Black, Heterogeneous, Non-Fibrous, Mastic			
Asbestos Types: Chrysotile 3.0 %			
Other Material: Cellulose 3 %, Non-fibrous 94 %			

**PLM Bulk Asbestos Report**

L001; AHERA; Mount Pleasant Els

Client No. / HGA	Lab No.	Asbestos Present	Total % Asbestos
29-1 Location: Floor Tile  Analyst Description: Off White, Homogeneous, Non-Fibrous, Floor Tile Asbestos Types: Chrysotile 2.0 % Other Material: Non-fibrous 98 %	108061421-24	Yes	2 % (by CVES) by C. David Mintz on 06/16/08
29-2 Location: Floor Tile  Analyst Description: Off White, Homogeneous, Non-Fibrous, Floor Tile Asbestos Types: Chrysotile 2.0 % Other Material: Non-fibrous 98 %	108061421-25	Yes	2 % (by CVES) by C. David Mintz on 06/16/08
30-1 Location: Floor Tile Mastic  Analyst Description: Black, Heterogeneous, Non-Fibrous, Mastic Asbestos Types: Chrysotile 4.0 % Other Material: Non-fibrous 96 %	108061421-26	Yes	4 % (by CVES) by C. David Mintz on 06/16/08
30-2 Location: Floor Tile Mastic  Analyst Description: Black, Heterogeneous, Non-Fibrous, Mastic Asbestos Types: Chrysotile 4.0 % Other Material: Non-fibrous 96 %	108061421-27	Yes	4 % (by CVES) by C. David Mintz on 06/16/08
31-1 Location: Floor Tile  Analyst Description: Off White, Homogeneous, Non-Fibrous, Floor Tile Asbestos Types: Chrysotile 2.0 % Other Material: Non-fibrous 98 %	108061421-28	Yes	2 % (by CVES) by C. David Mintz on 06/16/08
31-2 Location: Floor Tile  Analyst Description: Off White, Homogeneous, Non-Fibrous, Floor Tile Asbestos Types: Chrysotile 2.0 % Other Material: Non-fibrous 98 %	108061421-29	Yes	2 % (by CVES) by C. David Mintz on 06/16/08

**PLM Bulk Asbestos Report**

L001; AHERA; Mount Pleasant Els

Client No. / HGA	Lab No.	Asbestos Present	Total % Asbestos
32-1 Location: Floor Tile Mastic  Analyst Description: Black, Heterogeneous, Non-Fibrous, Mastic Asbestos Types: Chrysotile 3.0 % Other Material: Cellulose 3 %, Non-fibrous 94 %	108061421-30	Yes	3 % (by CVES) by C. David Mintz on 06/16/08
32-2 Location: Floor Tile Mastic  Analyst Description: Black, Heterogeneous, Non-Fibrous, Mastic Asbestos Types: Chrysotile 3.0 % Other Material: Cellulose 3 %, Non-fibrous 94 %	108061421-31	Yes	3 % (by CVES) by C. David Mintz on 06/16/08
33-1 Location: Floor Tile  Analyst Description: Dark Brown, Homogeneous, Non-Fibrous, Cementitious, Bulk Material Asbestos Types: Chrysotile 10.0 % Other Material: Non-fibrous 90 %	108061421-32	Yes	10 % (by CVES) by Donna M. Blackwell on 06/16/08
33-2 Location: Floor Tile  Analyst Description: Dark Brown, Homogeneous, Non-Fibrous, Cementitious, Bulk Material Asbestos Types: Chrysotile 10.0 % Other Material: Non-fibrous 90 %	108061421-33	Yes	10 % (by CVES) by Donna M. Blackwell on 06/16/08
34-1 Location: Floor Tile Mastic  Analyst Description: Black, Homogeneous, Non-Fibrous, Bulk Material Asbestos Types: Chrysotile 8.0 % Other Material: Non-fibrous 92 %	108061421-34	Yes	8 % (by CVES) by Donna M. Blackwell on 06/16/08
34-2 Location: Floor Tile Mastic  Analyst Description: Black, Homogeneous, Non-Fibrous, Cementitious, Bulk Material Asbestos Types: Chrysotile 8.0 % Other Material: Non-fibrous 92 %	108061421-35	Yes	8 % (by CVES) by Donna M. Blackwell on 06/16/08

Client Name: Baratta &amp; Associates, Inc.

**PLM Bulk Asbestos Report**

L001; AHERA; Mount Pleasant Els

Client No. / HGA	Lab No.	Asbestos Present	Total % Asbestos
35-1 Location: Floor Tile	108061421-36	No	NAD (by CVES) by William M. Dunstan on 06/16/08
<b>Analyst Description:</b> Gray, Heterogeneous, Non-Fibrous, Bulk Material <b>Asbestos Types:</b> <b>Other Material:</b> Non-fibrous 100 %			
35-2 Location: Floor Tile	108061421-37	No	NAD (by CVES) by William M. Dunstan on 06/16/08
<b>Analyst Description:</b> Gray, Heterogeneous, Non-Fibrous, Bulk Material <b>Asbestos Types:</b> <b>Other Material:</b> Non-fibrous 100 %			
36-1 Location: Floor Tile Mastic	108061421-38	No	NAD (by CVES) by William M. Dunstan on 06/16/08
<b>Analyst Description:</b> Yellow, Heterogeneous, Non-Fibrous, Bulk Material <b>Asbestos Types:</b> <b>Other Material:</b> Non-fibrous 100 %			
36-2 Location: Floor Tile Mastic	108061421-39	Yes	3 % (by CVES) by William M. Dunstan on 06/16/08
<b>Analyst Description:</b> Black/Brown, Heterogeneous, Non-Fibrous, Bulk Material <b>Asbestos Types:</b> Chrysotile 3.0 % <b>Other Material:</b> Non-fibrous 97 %			
37-1 Location: Floor Tile	108061421-40	Yes	7 % (by CVES) by William M. Dunstan on 06/16/08
<b>Analyst Description:</b> Dark Brown, Heterogeneous, Non-Fibrous, Bulk Material <b>Asbestos Types:</b> Chrysotile 7.0 % <b>Other Material:</b> Non-fibrous 93 %			
37-2 Location: Floor Tile	108061421-41	Yes	7 % (by CVES) by William M. Dunstan on 06/16/08
<b>Analyst Description:</b> Dark Brown, Heterogeneous, Non-Fibrous, Bulk Material <b>Asbestos Types:</b> Chrysotile 7.0 % <b>Other Material:</b> Non-fibrous 93 %			



**PLM Bulk Asbestos Report**

L001; AHERA; Mount Pleasant Els

Client No. / HGA	Lab No.	Asbestos Present	Total % Asbestos
38-1	108061421-42	Yes	8 %
Location: Floor Tile Mastic (not mastic "T")			(by CVES) by William M. Dunstan on 06/16/08
<b>Analyst Description:</b> Black, Heterogeneous, Non-Fibrous, Bulk Material <b>Asbestos Types:</b> Chrysotile 8.0 % <b>Other Material:</b> Non-fibrous 92 %			
38-2	108061421-43	Yes	8 %
Location: Floor Tile Mastic (not mastic "T")			(by CVES) by William M. Dunstan on 06/16/08
<b>Analyst Description:</b> Black, Heterogeneous, Non-Fibrous, Bulk Material <b>Asbestos Types:</b> Chrysotile 8.0 % <b>Other Material:</b> Non-fibrous 92 %			
39-1	108061421-44	No	NAD
Location: Floor Tile			(by CVES) by William M. Dunstan on 06/16/08
<b>Analyst Description:</b> White, Heterogeneous, Non-Fibrous, Bulk Material <b>Asbestos Types:</b> <b>Other Material:</b> Non-fibrous 100 %			
39-2	108061421-45	No	NAD
Location: Floor Tile			(by CVES) by William M. Dunstan on 06/16/08
<b>Analyst Description:</b> White, Heterogeneous, Non-Fibrous, Bulk Material <b>Asbestos Types:</b> <b>Other Material:</b> Non-fibrous 100 %			
40-1	108061421-46	Yes	5 %
Location: Floor Tile Mastic			(by CVES) by William M. Dunstan on 06/16/08
<b>Analyst Description:</b> Black, Heterogeneous, Non-Fibrous, Bulk Material <b>Asbestos Types:</b> Chrysotile 5.0 % <b>Other Material:</b> Non-fibrous 95 %			
40-2	108061421-47	Yes	5 %
Location: Floor Tile Mastic			(by CVES) by William M. Dunstan on 06/16/08
<b>Analyst Description:</b> Black, Heterogeneous, Non-Fibrous, Bulk Material <b>Asbestos Types:</b> Chrysotile 5.0 % <b>Other Material:</b> Non-fibrous 95 %			

Client Name: Baratta &amp; Associates, Inc.

**PLM Bulk Asbestos Report**

L001; AHERA; Mount Pleasant Els

Client No. / HGA	Lab No.	Asbestos Present	Total % Asbestos
41-1 Location: Floor Tile	108061421-48	No	NAD (by CVES) by William M. Dunstan on 06/16/08
<b>Analyst Description:</b> White/Brown, Heterogeneous, Non-Fibrous, Bulk Material <b>Asbestos Types:</b> <b>Other Material:</b> Non-fibrous 100 %			
41-2 Location: Floor Tile	108061421-49	No	NAD (by CVES) by William M. Dunstan on 06/16/08
<b>Analyst Description:</b> White/Brown, Heterogeneous, Non-Fibrous, Bulk Material <b>Asbestos Types:</b> <b>Other Material:</b> Non-fibrous 100 %			
42-1 Location: Floor Tile Mastic	108061421-50	No	NAD (by CVES) by William M. Dunstan on 06/16/08
<b>Analyst Description:</b> Brown, Heterogeneous, Non-Fibrous, Bulk Material <b>Asbestos Types:</b> <b>Other Material:</b> Non-fibrous 100 %			
42-2 Location: Floor Tile Mastic	108061421-51	No	NAD (by CVES) by William M. Dunstan on 06/16/08
<b>Analyst Description:</b> Brown, Heterogeneous, Non-Fibrous, Bulk Material <b>Asbestos Types:</b> <b>Other Material:</b> Non-fibrous 100 %			
43-1 Location: Floor Tile	108061421-52	Yes	3 % (by CVES) by William M. Dunstan on 06/16/08
<b>Analyst Description:</b> Beige, Heterogeneous, Non-Fibrous, Bulk Material <b>Asbestos Types:</b> Chrysotile 3.0 % <b>Other Material:</b> Non-fibrous 97 %			
43-2 Location: Floor Tile	108061421-53	Yes	3 % (by CVES) by William M. Dunstan on 06/16/08
<b>Analyst Description:</b> Beige, Heterogeneous, Non-Fibrous, Bulk Material <b>Asbestos Types:</b> Chrysotile 3.0 % <b>Other Material:</b> Non-fibrous 97 %			

Client Name: Baratta &amp; Associates, Inc.

**PLM Bulk Asbestos Report**

L001; AHERA; Mount Pleasant Els

Client No. / HGA	Lab No.	Asbestos Present	Total % Asbestos
44-1	108061421-54	Yes	5 %
Location: Floor Tile Mastic			(by CVES) by William M. Dunstan on 06/16/08
Analyst Description: Black, Heterogeneous, Non-Fibrous, Bulk Material			
Asbestos Types: Chrysotile 5.0 %			
Other Material: Non-fibrous 95 %			
44-2	108061421-55	Yes	5 %
Location: Floor Tile Mastic			(by CVES) by William M. Dunstan on 06/16/08
Analyst Description: Black, Heterogeneous, Non-Fibrous, Bulk Material			
Asbestos Types: Chrysotile 5.0 %			
Other Material: Non-fibrous 95 %			
45-1	108061421-56	No	NAD
Location: Acoustic Ceiling Tile			(by CVES) by William M. Dunstan on 06/16/08
Analyst Description: Tan, Heterogeneous, Fibrous, Bulk Material			
Asbestos Types:			
Other Material: Cellulose 95 %, Non-fibrous 5 %			
45-2	108061421-57	No	NAD
Location: Acoustic Ceiling Tile			(by CVES) by William M. Dunstan on 06/16/08
Analyst Description: Tan, Heterogeneous, Fibrous, Bulk Material			
Asbestos Types:			
Other Material: Cellulose 95 %, Non-fibrous 5 %			

**Reporting Notes:**

Analyzed by: Donna M. Blackwell

Date

6/16/08

\*NAD = no asbestos detected, Detection Limit <1%, Reporting Limits: CVES = 1%, 400 Pt Ct = 0.25%, 1000 Pt Ct = 0.1%; "Present" or NVA = "No Visible Asbestos" are observations made during a qualitative analysis; NA = not analyzed; NA/PS = not analyzed / positive stop; PLM Bulk Asbestos Analysis by EPA 600/M4-82-020 per 40 CFR 763 (NVLAP Lab Code 101904-0) and ELAP PLM Analysis Protocol 198.1 for New York friable samples (198.6 for NOB samples)(NYSDOH ELAP Lab # 10984); CA ELAP Lab # 2508; Note: PLM is not consistently reliable in detecting asbestos in floor coverings and similar NOB materials. NAD or Trace results by PLM are inconclusive, TEM is currently the only method that can be used to determine if this material can be considered or treated as non-asbestos-containing in New York State (also see EPA Advisory for floor tile, FR 59, 146, 38970, 8/1/94). NIST Accreditation requirements mandate that this report must not be reproduced except in full without the approval of the laboratory. This PLM report relates ONLY to the items tested.

Reviewed By:

TJL

**Baratta & Associates, Inc.**

P.O. Box 293

Vinton, Virginia

LEA Roanoke County SchoolsSchool 023 Mount Pleasant Elementary SchoolBuilding Main**REASSESSMENT OF MATERIALS**Past or Initial Assessment: Hall-Kimbrell April 1989

Homogeneous Area	Description	Past Assessment Category #	Reassessment Category #
02	LIC	Non-ACM	-
03	LIC	Non-ACM	-
04	Domestic HW fitting TSI	1	6
05	Domestic CW fitting TSI	1	Removed
06	LPS pipe TSI	1	1
07	LPS fitting TSI	1	Removed
08	LPS aircell TSI	1	Removed
09	LPS fitting TSI on aircell lines	1	Removed
10	Floor tile 12" x12", tan	5	Removed
11	Floor tile 12" x12", olive	5	Removed
12A	Floor tile 9"x9", brown	5	5
12B	Black mastic for HA-12A	Not evaluated	5
13	Floor tile 9"x9", white	5	Removed
14A	Floor tile 9"x9", tan	5	5
14B	Black mastic for HA-14A	Not evaluated	5
15	Floor tile 12" x12", tan	5	Removed
16	Floor tile 9"x9" green	5	Removed
17	Boiler TSI	1	6
18	Breeching TSI	1	6
19	Fitting TSI in Boiler Room	1	6
20	Pipe TSI in Boiler Room	1	6
21	Fitting TSI in Tunnels (see HA-19)	Not evaluated	1
22	Pipe TSI in Tunnels (see HA-20)	Not evaluated	1
23	Plaster	Not evaluated	Non-ACM
24	Tan mastic for blue carpet	Not evaluated	Non-ACM
25	Floor tile 12" x12", white under HA-24	Not evaluated	5
26	Black mastic for HA-25	Not evaluated	5
27	Floor tile 12" x12", tan with brown & white	Not evaluated	5
28	Black mastic for HA-27	Not evaluated	5
29	Floor tile 12" x12", cream with almond	Not evaluated	5
30	Black mastic for HA-29	Not evaluated	5
31	Floor tile 12" x12", white with grey streaks	Not evaluated	5
32	Black mastic for HA-31	Not evaluated	5

Homogeneous Area	Description	Past Assessment Category #	Reassessment Category #
33	Brown floor tile under HA-31	Not evaluated	5
34	Black mastic for HA-33	Not evaluated	5
35	Floor tile 12" x12" grey with white & blue	Not evaluated	NAD
36	Tan mastic for HA-35	Not evaluated	5
37	Black floor tile under HA-35 in Special Education W	Not evaluated	5
38	Black mastic for HA-37	Not evaluated	5
39	Floor tile 12" x12" white with cream	Not evaluated	NAD
40	Black mastic for HA-39	Not evaluated	5
41	Floor tile 12" x12", white with taupe	Not evaluated	NAD
42	Brown mastic for HA-41	Not evaluated	NAD
43	White floor tile under HA-41	Not evaluated	5
44	Black mastic for HA-43	Not evaluated	5
45	ACT 12"x12"	Not evaluated	NAD

AHERA - Physical Assessment Categories - 763.88(a)(2)(b)

- 1 Damaged or significantly damaged TSI-ACBM
- 2 Damaged friable surfacing ACBM
- 3 Significantly damaged friable surfacing ACBM
- 4 Damaged or significantly damaged friable miscellaneous ACBM
- 5 ACBM with potential for damage
- 6 ACBM with potential for significant damage
- 7 Any remaining friable ACBM or friable suspect ACBM

Inspector:

Name: Michael Baratta Signature

Date 7/23/09

Accreditation Number: 3303 000065 Agency: Virginia DPOR

# LOCATION OF ACBMs

First Floor Scale: see drawing

Reinspection Date: June 10, 2008

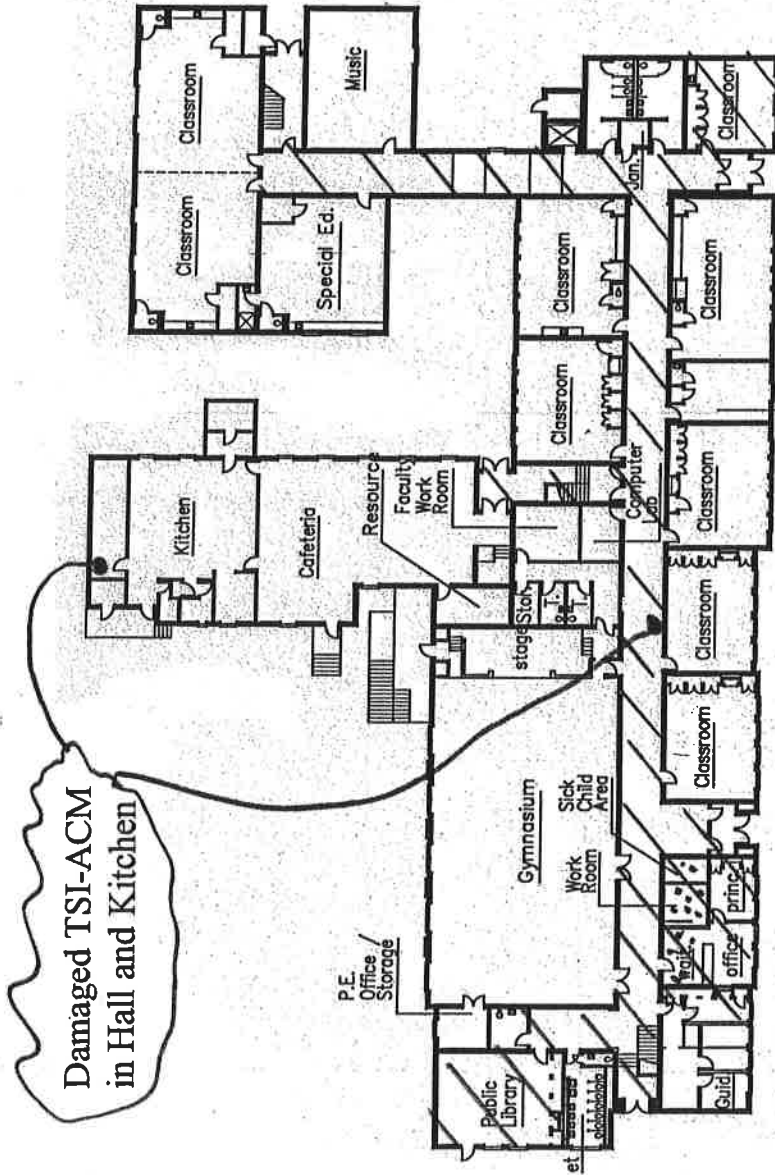

	Asbestos containing floor tiles and mastics
	Asbestos containing floor tile mastics (tiles are non-ACMs)
	TSI-ACM in Basement

TSI-ACM hidden inside walls and ceiling spaces - Typical

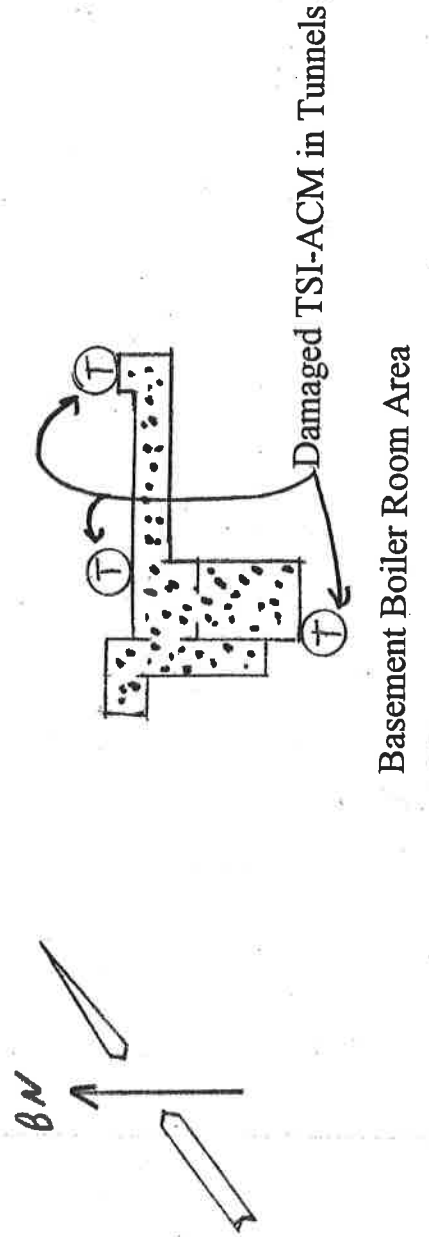

LOCATION OF ACBMs

Second Floor

Scale: see drawing

Reinspection Date: June 10, 2008

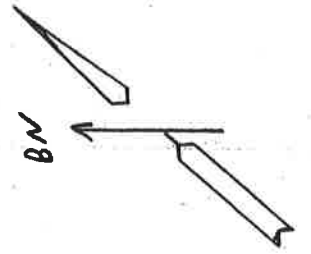
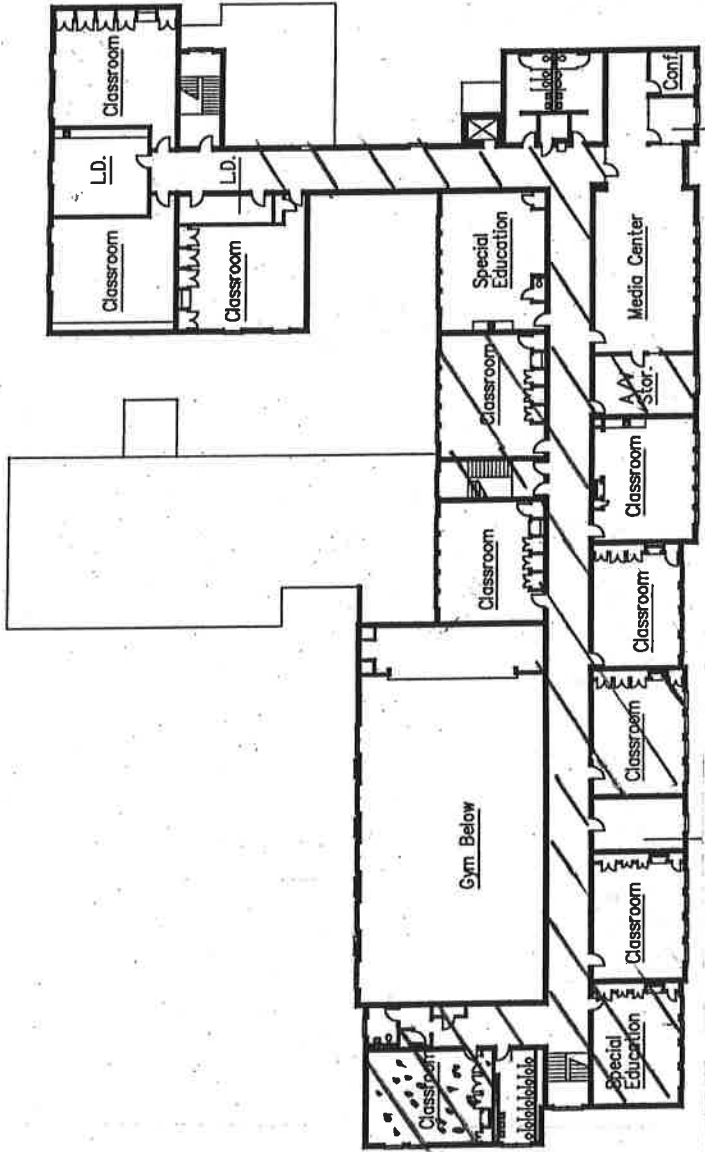

	Asbestos containing floor tiles and mastics
	Asbestos containing floor tile mastics (tiles are non-ACMs)

TSI-ACM hidden inside walls and ceiling spaces - Typical

Virginia Department of Education  
Energy and Facilities Service

LEA Roanoke County Schools  
School 023 Mount Pleasant Elementary School  
Building: Main

**RESPONSE ACTIONS  
RECOMMENDED**

Total cost to remove \$139,000

Each Location	Recommended Response Actions	Scheduled To Begin	Scheduled To Be Completed	Est. Cost To Remove
Damaged TSI-ACM in Hall and Kitchen (HA-04 and HA-06)	Remove	August 2008	August 2008	\$4,000
Damaged TSI-ACM in Tunnels (HA-21 and HA-22)	Seal and install asbestos warning signs. Place in O & M Plan until removed	none	none	\$80,000
TSI-ACM in Basement (Boiler Room Area)	Place in O & M Plan until removed	none	none	\$20,000
Floor tiles and mastics	Place in O & M Plan until removed	none	none	\$35,000

Management Planner:

Name: Michael Baratta Signature 

Date 7/23/09

Accreditation Number: 3304 000208

Agency: Virginia DPOR



## **ASBESTOS MANAGEMENT, OPERATIONS AND MAINTENANCE PLAN**

Mount Pleasant Elementary School  
July 23, 2008

This Asbestos Management Operations and Maintenance Plan is based on the Three Year AHERA Reinspection performed by Baratta & Associates, Inc on June 10, 2008. It covers procedures to be followed in dealing with the Asbestos-Containing Materials (ACMs) found in the Mount Pleasant Elementary School.

### **SUMMARY**

The thermal system insulation (TSI) in the boiler room is an ACM. These materials appeared to be in good condition.

Significantly damaged TSI-ACM exists in the tunnels.

Three (3) pieces of asbestos containing TSI exist in the first floor hall and kitchen. These should be removed as soon as possible.

Numerous asbestos containing floor tiles and mastics also exist in the Mount Pleasant Elementary School Building.

### **STAFF NOTIFICATION**

The School should send all staff members a brief notice stating that Asbestos-Containing Materials exist in the Mount Pleasant Elementary School.

### **ACM IDENTIFICATION**

The following products were found to be Asbestos-Containing Materials (ACMs):

<b>HA Number</b>	<b>Material</b>
04	Domestic HW fitting TSI
06	LPS pipe TSI
12A	Floor tile 9"x9", brown
12B	Black mastic for HA-12A
14A	Floor tile 9"x9", tan
14B	Black mastic for HA-14A
17	Boiler TSI
18	Breeching TSI
19	Fitting TSI in Boiler Room
20	Pipe TSI in Boiler Room
21	Fitting TSI in Tunnels (see HA-19)

HA Number	Material
22	Pipe TSI in Tunnels (see HA-20)
25	Floor tile 12" x12", white under HA-24
26	Black mastic for HA-25
27	Floor tile 12" x12", tan with brown & white
28	Black mastic for HA-27
29	Floor tile 12" x12", cream with almond
30	Black mastic for HA-29
31	Floor tile 12" x12", white with grey streaks
32	Black mastic for HA-31
33	Brown floor tile under HA-31
34	Black mastic for HA-33
36	Tan mastic for 12" x12" grey with white & blue floor tile HA-35
37	Black floor tile under HA-35 in Special Education W
38	Black mastic for HA-37
40	Black mastic for white with cream 12" x12 floor tile HA-39
42	Brown mastic for white with taupe 12" x12" floor tile HA-41
43	White floor tile under HA-41
44	Black mastic for HA-43

### **REMOVAL OF THERMAL SYSTEM INSULATION (TSI) IN FIRST FLOOR HALL AND KITCHEN**

A vertical pipe exists on the south wall, near the center, of the first floor hall. In addition, two (2) insulated pipe fittings serve a sink in the Kitchen. Due to the high probability of disturbance, we recommend these TSIs be removed and replaced with non-asbestos containing insulation. This should be carried out as soon as possible.

### **CARE OF THE THERMAL SYSTEM INSULATION (TSI) IN TUNNELS**

These tunnels are under the first floor. Any ACMs in the tunnels do not present an asbestos related health hazard to those occupying the main floor.

The tunnels should be sealed off to prevent entry by unauthorized personnel. An asbestos warning label should be applied to the tunnel entrance.

### **CARE OF THE THERMAL SYSTEM INSULATION (TSI) IN CONCEALED SPACES**

These ACMs are hidden in the walls and ceiling spaces. They do not present an asbestos related health hazard to those occupying the building.

## **CARE OF THE THERMAL SYSTEM INSULATION (TSI) IN BOILER ROOM**

An asbestos warning sign should be applied to all doors leading to the Boiler Room.

Custodial and maintenance personnel should take care not to damage or disturb the TSI while performing their duties. Any damaged areas should be reported to the Principal so repairs can be made.

Any patching, repair work or removal should be carried out by a licensed asbestos abatement contractor.

## **CARE OF THE FLOOR TILES**

All halls and about 25% of the rooms have asbestos containing floor tiles and mastic on their floors.

No drilling, sanding, or other abrasive or penetrating activities shall be used on the asbestos containing floor tiles. To do so may release asbestos fibers into the environment.

The flooring is tough and non-friable. It is doubtful anything other than forceful vandalism will deteriorate this material to a point where significant fiber release will occur.

## **CARE OF THE FLOOR MASTICS**

Newer non-asbestos containing floor tile had been installed in Room 201 and in portions of the Office. The old mastic under these tiles is an ACM. Since the mastic is covered with a durable non-asbestos containing product the likelihood of the mastic becoming an asbestos related health hazard is remote.

Again, no drilling, sanding, or other abrasive or penetrating activities shall be used on the floor tiles. To do so may disturb the mastic thus release asbestos fibers into the environment.

## **PERMIT REQUIREMENTS**

Before any work that may require the disturbance of the noted Asbestos Containing Materials is performed, maintenance personnel or contractors shall obtain an Asbestos Work Area Permit from the School System's Asbestos Program Manager.